

## M006

JUWO FACTSHEET: LAUNDRY ROOM REGULATIONS

# LAUNDRY ROOM REGULATIONS

THE LAUNDRY ROOM REGULATIONS ARE PART OF THE HOUSE RULES



## WASHING MACHINE

- The washing machine filter must be checked after use. Dirt and fiber residue must be removed.
- The detergent compartment has to be cleaned from any residue and wiped with a damp cloth.
- The inner seal ring of the washing machine needs to be cleaned with a damp cloth.

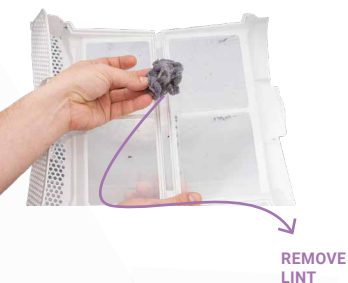

## DRYER

- Laundry that has been washed with fabric softener can not be dried with a dryer.
- Clean the corresponding filters in the door and/or on the inside or back of the dryer and completely remove any fiber residue.
- The lint and fiber residue from the filters have to be disposed in your own waste (do not throw them behind the machine!).



## GENERAL INFORMATION

- Washing is allowed from 7 a.m. to 10 p.m. It is not allowed to wash on Sundays and public holidays.
- No sharp cleaning agents or abrasive materials such as steel wool should be used to clean the machines.
- Laundry and drying rooms must be wiped down after use.
- Empty detergent packages and lint from the dryer should be disposed in your own waste.
- You may only hang up your laundry in the washroom until it is completely dry. It is forbidden to deposit objects or clothes on the floor.
- The laundry room should be left clean and tidy - as you would like it to be when you arrive.
- If you are unsure about how to use the washing machine, consult the user's manuals or ask your neighbors for advice.



THANK YOU FOR RESPECTING THE LAUNDRY ROOM RULES. YOUR HELP WILL  
PAY OFF **BECAUSE LONG-TERM DAMAGES DUE TO INSUFFICIENT MAINTENANCE WILL  
BE CHARGED ENTIRELY TO THE TENANTS.**